

BY	DESCRIPTION OF WORK	DATE
PHG	Remove good for DEIS	12/1/05
PHG	Update for DEIS	12/28/06

DETAILS	
Date: February 13, 2007	
Horizontal Scale: 1" = 100'	
Vertical Scale: 1" = 100'	
Datum: MSL	
Project Manager: PHG	
Drawn by: JMO	
Checked by: PHG	

RED WING PROPERTIES, INC.
 Archer Mine
 Town of Milan
 Dutchess County, New York

TYPICAL SECTIONS
A-A', B-B', C-C' & D-D'
 for
 New York State Department of
 Environmental Conservation



Griggs-Lang Consulting Geologists, Inc.
 8 Brunswick Road Troy, New York 12180
 Phone: (518) 270-8920 Fax: (518) 270-8920

LEGEND

- Existing Topography
- Proposed Topography
- Water
- Paved Road
- Unpaved Road
- Proposed Haul Road
- Berm
- Planned Berm

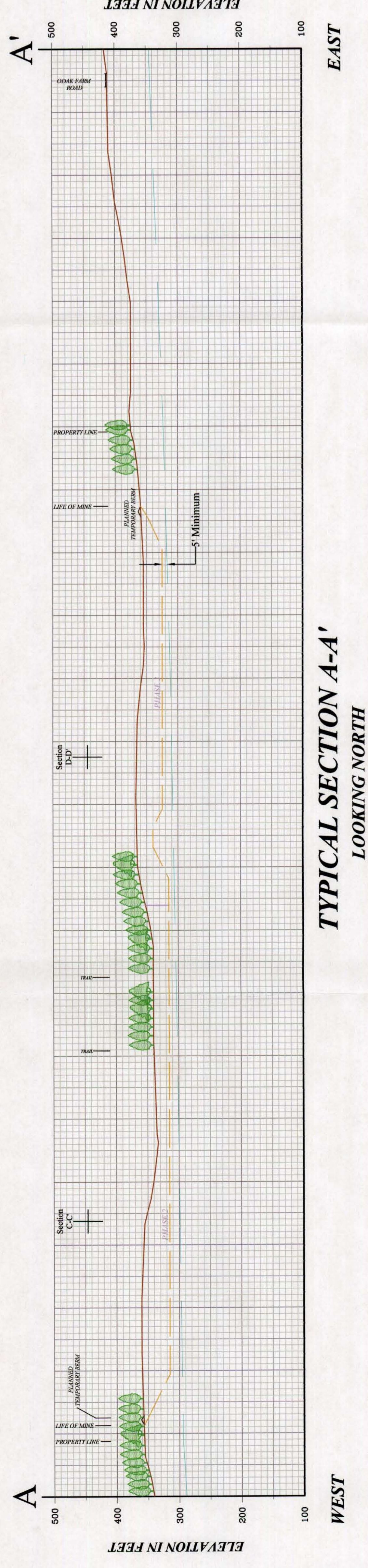

TYPICAL SECTION A-A'
 LOOKING NORTH

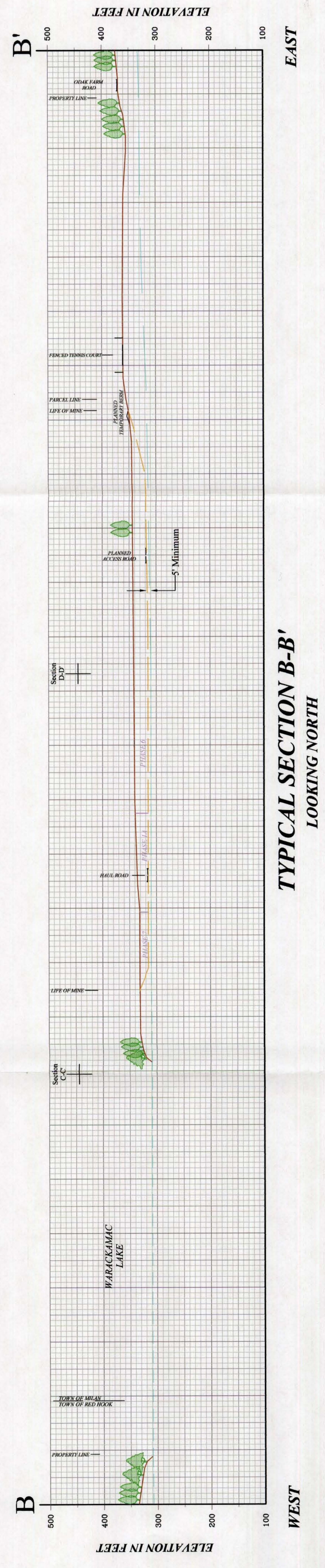

TYPICAL SECTION B-B'
 LOOKING NORTH

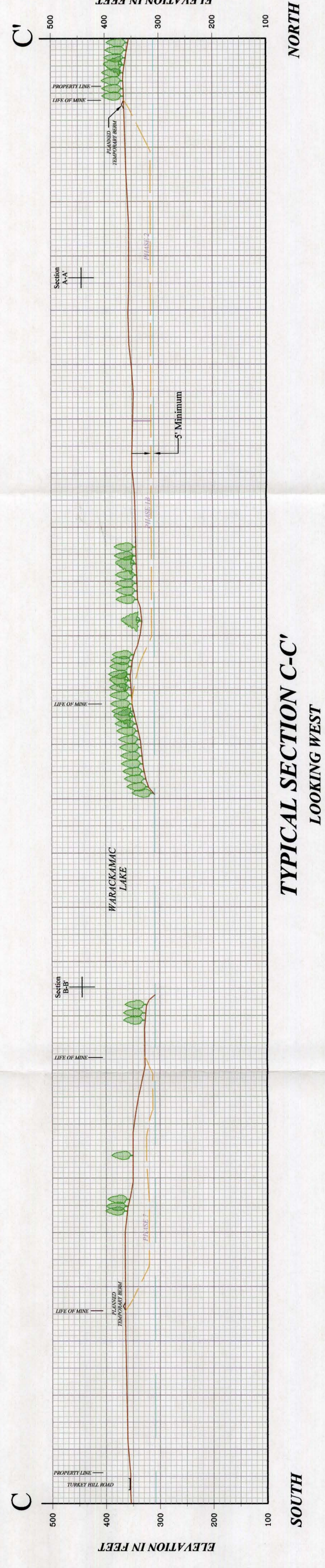

TYPICAL SECTION C-C'
 LOOKING WEST

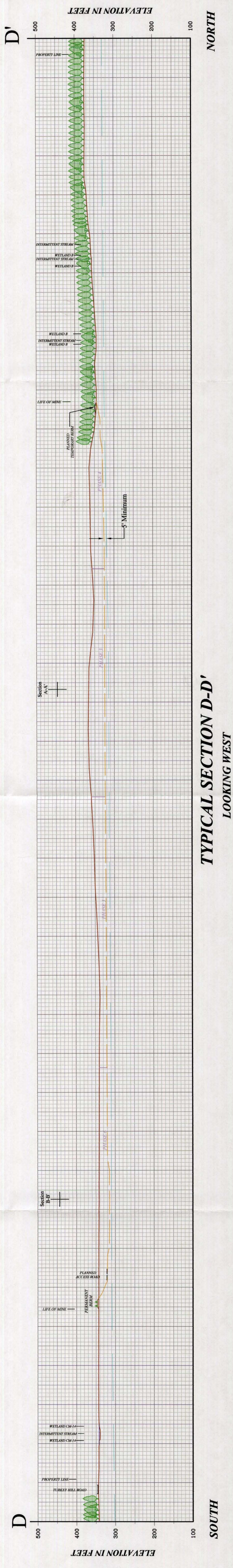

TYPICAL SECTION D-D'
 LOOKING WEST