

SECTION C
Scale: 1" = 20'

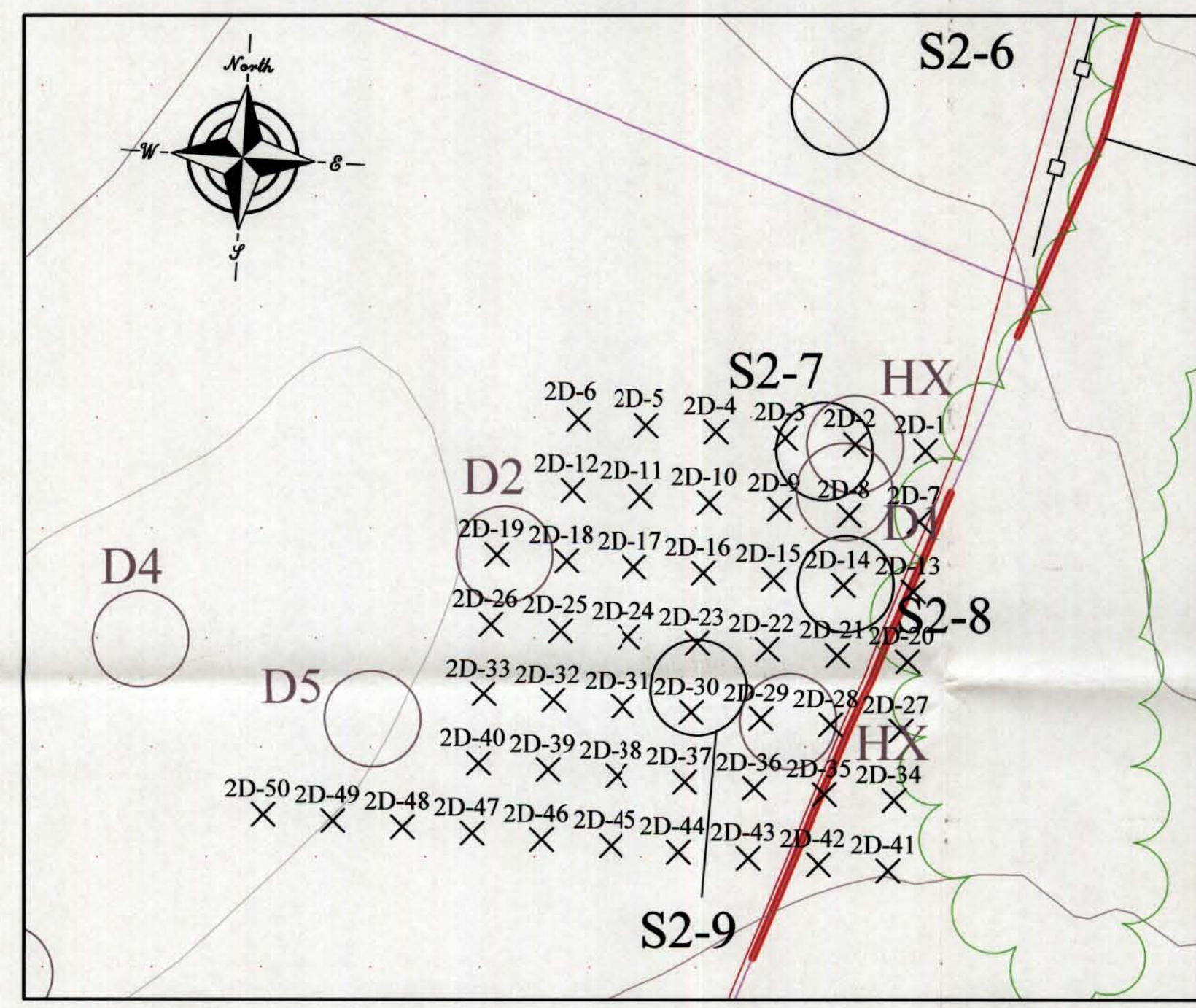

SECTION D
Scale: 1" = 20'

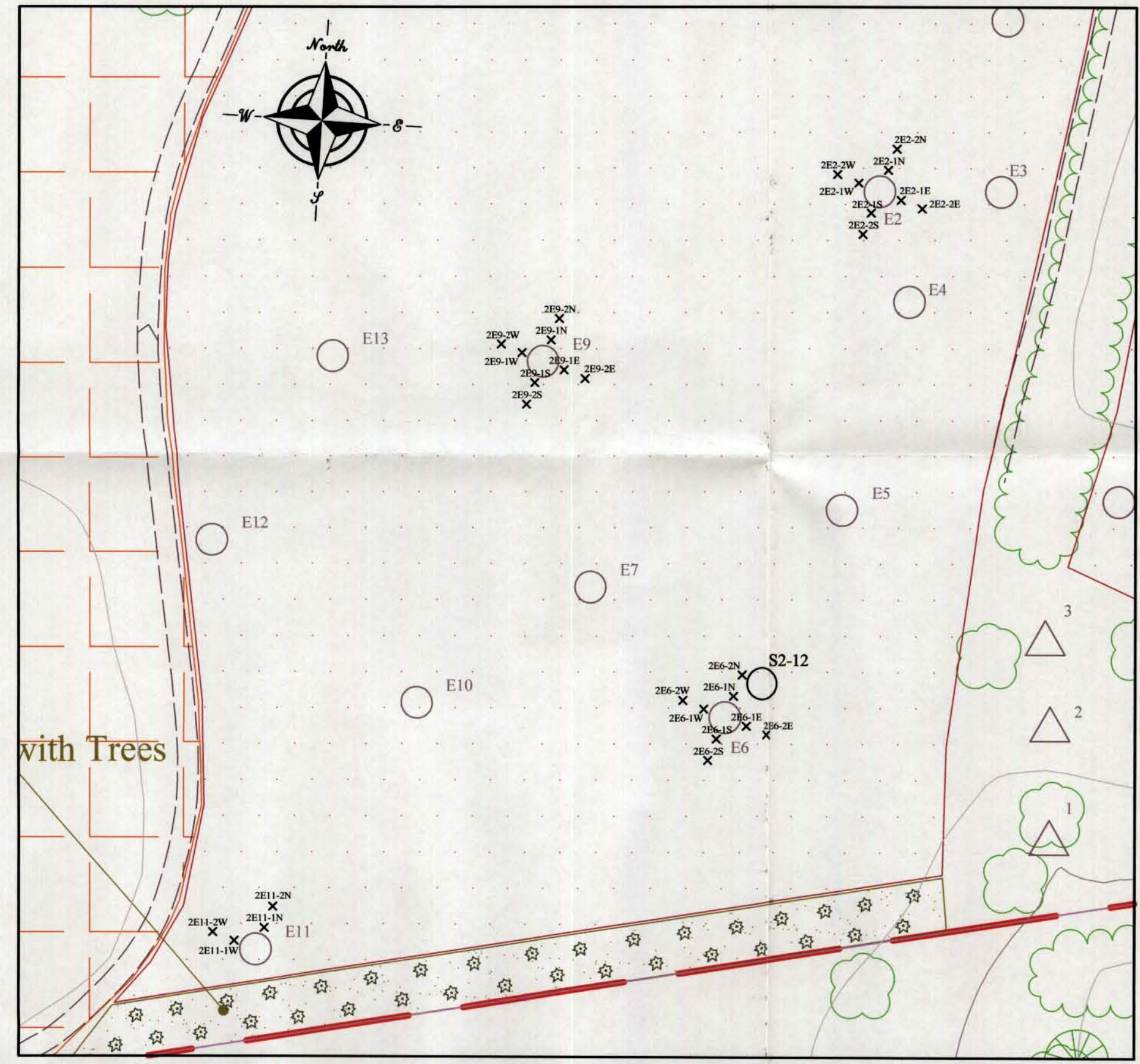

SECTION E
Scale: 1" = 50'

RED WING PROPERTIES, INC. Archer Mine Town of Milan, Dutchess County, New York Site Map Showing Location and Detail of Phase II Cultural Resources Investigation	DETAILS Date: February 20, 2004 Scale: 1" = 200' Contour Interval: 5' Datum: MSL Project Manager: PHG Drafted by: JMO Checked by: PHG			MAP REVISIONS <table border="1"> <thead> <tr> <th>BY</th> <th>DESCRIPTION OF WORK</th> <th>DATE</th> </tr> </thead> <tbody> <tr> <td> </td> <td> </td> <td> </td> </tr> <tr> <td> </td> <td> </td> <td> </td> </tr> <tr> <td> </td> <td> </td> <td> </td> </tr> </tbody> </table>			BY	DESCRIPTION OF WORK	DATE										LEGEND <table border="1"> <tr> <td></td> <td>Life of Mine Area</td> <td></td> <td>Paved Road</td> </tr> <tr> <td></td> <td>Approx. Property Line</td> <td></td> <td>Unpaved Road</td> </tr> <tr> <td></td> <td>Contour, 25'</td> <td></td> <td>Building/Structure</td> </tr> <tr> <td></td> <td>Contour, 5'</td> <td></td> <td>Utility Pole</td> </tr> <tr> <td></td> <td>Edge of Water</td> <td></td> <td>Fence</td> </tr> <tr> <td></td> <td>Berm</td> <td></td> <td>Trees; Deciduous, Coniferous</td> </tr> <tr> <td></td> <td>Plantings</td> <td></td> <td>Wooded Area</td> </tr> </table>				Life of Mine Area		Paved Road		Approx. Property Line		Unpaved Road		Contour, 25'		Building/Structure		Contour, 5'		Utility Pole		Edge of Water		Fence		Berm		Trees; Deciduous, Coniferous		Plantings		Wooded Area	Archaeological Key <table border="1"> <tr> <td></td> <td>Plowed/Visually Inspected Areas</td> <td></td> <td>Location of Flag (Phase 1)</td> <td></td> <td>Location of Flag (Phase 2)</td> </tr> <tr> <td></td> <td>Disturbed Area</td> <td></td> <td>Shovel Test Pits (Phase 1)</td> <td></td> <td>Shovel Test Location (Phase 2)</td> </tr> <tr> <td></td> <td>Slope >15%</td> <td></td> <td>Photo Location (Phase 1)</td> <td></td> <td>Shovel Test Location (Phase 2)</td> </tr> <tr> <td></td> <td>Potentially Eligible Structure</td> <td></td> <td>Location of Flag (Phase 2)</td> <td></td> <td>Shovel Test Location (Phase 2)</td> </tr> </table>				Plowed/Visually Inspected Areas		Location of Flag (Phase 1)		Location of Flag (Phase 2)		Disturbed Area		Shovel Test Pits (Phase 1)		Shovel Test Location (Phase 2)		Slope >15%		Photo Location (Phase 1)		Shovel Test Location (Phase 2)		Potentially Eligible Structure		Location of Flag (Phase 2)		Shovel Test Location (Phase 2)
	BY	DESCRIPTION OF WORK	DATE																																																																									
	Life of Mine Area		Paved Road																																																																									
	Approx. Property Line		Unpaved Road																																																																									
	Contour, 25'		Building/Structure																																																																									
	Contour, 5'		Utility Pole																																																																									
	Edge of Water		Fence																																																																									
	Berm		Trees; Deciduous, Coniferous																																																																									
	Plantings		Wooded Area																																																																									
	Plowed/Visually Inspected Areas		Location of Flag (Phase 1)		Location of Flag (Phase 2)																																																																							
	Disturbed Area		Shovel Test Pits (Phase 1)		Shovel Test Location (Phase 2)																																																																							
	Slope >15%		Photo Location (Phase 1)		Shovel Test Location (Phase 2)																																																																							
	Potentially Eligible Structure		Location of Flag (Phase 2)		Shovel Test Location (Phase 2)																																																																							
Griggs-Lang Consulting Geologists, Inc. 679 Plank Road Clifton Park, New York 12065 Phone: (518) 373-7078 Fax: (518) 373-7080	<small> 1) Survey Map by Harry J. Bly, L.S. revised 1/19/88 2) Aerial Photogrammetric Map by Col. East, Inc., dated 9/4/02 3) Site Map Showing Phase I Cultural Resources Study, dated February 13, 2003 </small>																																																																											